

FOR LEASE

Edison Park Shopping Center Hartville, Ohio

1,350 - 5,180 square feet available



Description: 864 West Maple Street. Located West of Route 43. Total size of the center is 137,168 sq ft.

Co-Tenants: Inline with Marc's, Big Lots, Goodwill, Verizon, Burger King, First Merit, etc.

Nearby Tenants: Giant Eagle, McDonald's, Hartville Flea Market, Post Office, Taco Bell.

Demographics:

Population:

1 mile: 3,033

3 miles: 15,944

5 miles: 45,365

Average Household Income:

1 mile: \$72,716

3 miles: \$79,132

5 miles: \$81,384



For more information contact:

Craig Cohen

Craig@CohenCommercialGroup.com



Cohen Commercial Group
3690 Orange Place, Suite 111
Beachwood, Ohio 44122
(216) 223-5060

The information submitted herein is not guaranteed. Although obtained from reliable sources, it is subject to errors, omissions, prior sale/lease and withdrawal from the market without notice. Cohen Commercial Group, its affiliates, agents, and employees, and Seller/Landlord make no representations about the accuracy of said information and recommend individual investigation to certify its validity.

WEST MAPLE STREET

MILAN AVENUE

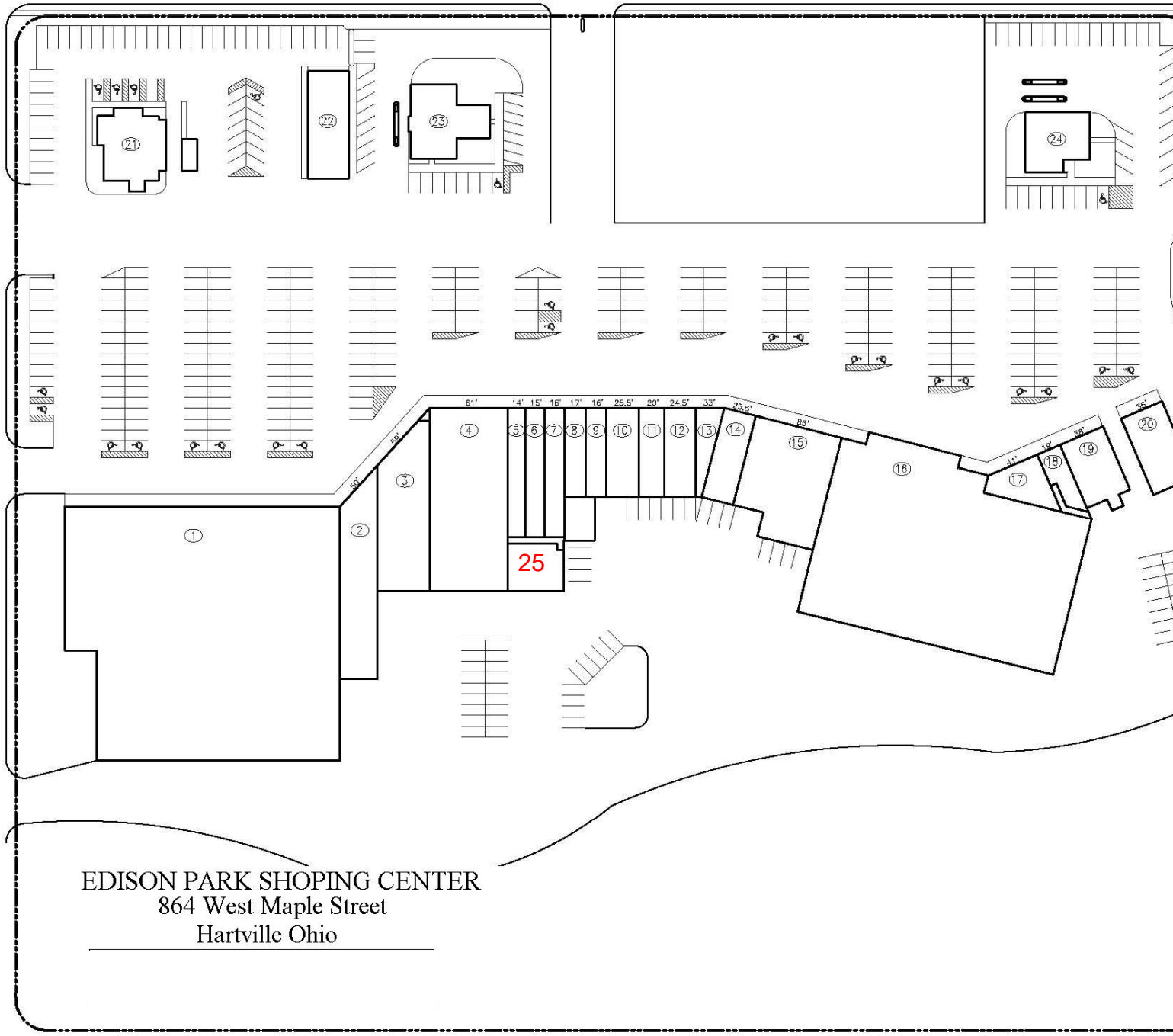

EDISON PARK SHOPPING CENTER
864 West Maple Street
Hartville Ohio

SUNNYSIDE STREET

#	TENANT	SF
1	MARC'S	44,902
2	BABY TYME FURNITURE	4,520
3	VACANT	3,755
4	GOODWILL INDUSTRIES	9,000
5	VACANT	1,500
6	VACANT	1,500
7	SHEAR POSSIBILITIES	1,500
8	VACANT	1,350
9	EAGLE NAILS	1,281
10	YODER MEDICAL	1,812
11	GNC	1,520
12	BEST CUTS	1,850
13	ROMEO'S PIZZA	1,475
14	VACANT	4,000
15	CONCORD THERAPY	6,000
16	BIG LOTS	30,292
17	SUBWAY	1,734
18	Pastore's Dry Cleaners	910
19	DAIRY QUEEN	2,052
20	MEXICAN RESTAURANT	2,300
21	BURGER KING	3,388
22	THE WIRELESS CENTER	3,500
23	KEY BANK	2,809
24	FIRST MERIT BANK	2,038
25	VACANT	2,180
	TOTAL:	137,168